

Guarnición apta para cilindros hidráulicos de simple o doble efecto, que no requiere una fina terminación y ajustadas tolerancias, También se fabrican en otros compuestos con caucho sintético acrílico-nitrilo y tela, soportando presiones de hasta 200 kg/cm².

Gaxeta apta para cilindros hidráulicos de simples ou duplo efeito, que não necessita de um fino acabamento e ajustes nas tolerâncias. Também são fabricadas em outros compostos como borrachas sintéticas, acrílico-nitrilo e tela suportando pressões de até 200 kg/cm².

This seal is able to simple or double hydraulic cylinders that not requires any delicate ending and adjusted tolerances. Besides they are made in other compounds whit NBR and hard fabric, supporting working pressures up to 200 kg/cm².

ESPAÑOL

PORTUGUES

ENGLISH

Tabla de Alojamientos y Tolerancias
Tabela de Alojamentos e Tolerâncias / Tolerances and Grooves Chart

Ø D Nominal	Ø D	Ø d
0-50	-0,20	Según requerimiento del cliente <i>De acordo com as requisitos do cliente. According to the client requirement</i>
51-100	-0,30	
101-150	-0,35	
151-200	-0,40	
201-250	-0,40	
251-300	-0,40	

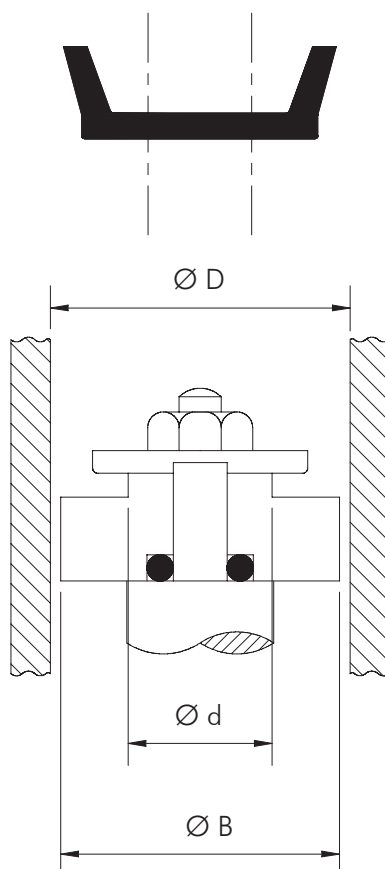

W-CP Poliuretano
W-CP Poliuretano / W-CP Polyurethane

Ø D mm	Ø D mm	Ø D mm	Ø D mm	Ø D mm
9,5	40,0	70,0	105,0	173,0
11,0	42,0	73,0	110,0	177,0
12,7	45,0	76,2	114,3	180,0
15,0	49,0	78,0	120,0	185,0
15,8	50,8	80,0	127,0	190,0
19,0	54,0	82,0	131,0	203,0
22,0	55,0	85,0	135,0	210,0
25,0	57,0	86,0	140,0	228,0
30,0	59,0	88,9	143,0	240,0
31,7	60,0	91,0	150,0	254,0
33,0	61,0	95,0	155,0	260,0
35,0	62,7	97,0	160,0	270,0
38,1	63,5	100,0	165,0	310,0
39,0	65,0	101,6	170,0	

W-CT Goma y Tela
W-CT borracha e tela / W-CT NBR and Hard fabric

Ø D mm	Ø d mm
63,5	32,0
76,2	44,0
80,0	50,0
88,9	51,5
100,0	40,0
101,6	47,0
114,0	76,2
114,3	31,7
127,0	70,0
139,7	80,0
152,4	78,0
177,8	101,6
177,8	110,0
246,0	190,0